

The Choice of Professionals



The Perfect Tool for the Perfect Bead



Tired of messy caulking installations? Color Rite's Mist product on silicone sealant beads, helps you do the clean up as you do the tooling. Helps to keep excess silicone from adhering to areas where silicone isn't wanted.

Mist helps you save clean up time and energy.

Create the perfect bead with Color Rite's Perfect Bead Tool. This caulking tool is designed to leave the correct size caulk bead in both vertical and horizontal joints and seams. The corners of the bead tool are designed to leave a 1/8 x 1/8 inch bead of caulk. Make your jobs and your life easier with Color Rite's Perfect Bead Tool.

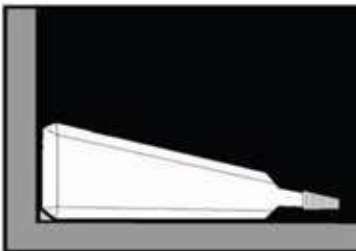

Note: Beveled edges are designed to function as a squeegee and must face direction of excess silicone removal. Small corner beveled edge pushes silicone into gap and leaves proper amount of silicone. If larger silicone bead is necessary, cut small corner beveled edge to desired shape to allow for more silicone and a larger bead.

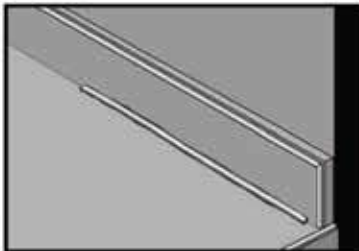

1.) Place small bead of Silicone in joint. Bead should be approximately 1/8" x 1/8" to avoid waste.

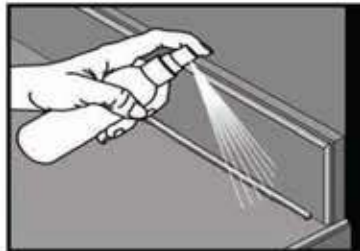

2.) Before tooling, spray MIST onto Silicone and the PERFECT BEAD TOOL to help smooth silicone bead during tooling. MIST also helps to keep excess silicone from adhering to areas where silicone is not wanted.

Profile of silicone bead as it is applied.

Profile of silicone bead after tooling with the PERFECT BEAD TOOL.

Use of the PERFECT BEAD TOOL eliminates feathered edges which contribute to silicone adhesion failures and unsightly silicone bead created using typical tooling procedures.

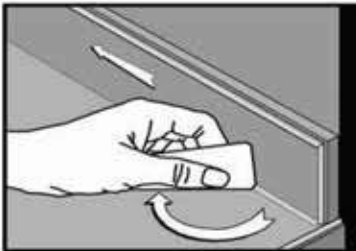

3.) Place longest beveled edge of the PERFECT BEAD TOOL on the horizontal surface and rotate small tip in direction of excess silicone removal.



Edges of tool must travel flush against vertical & horizontal surfaces.

4.) Tilt the PERFECT BEAD TOOL towards vertical splash surface until short beveled edge touches vertical splash surface.



5.) Using moderate pressure, move the PERFECT BEAD TOOL along silicone normally with one pass. Intermittent removal of excess silicone from tool is suggested for best performance. If smoother silicone bead is required repeat steps 2 through 5.

Profile of silicone bead as it is applied.

Profile of silicone bead after typical application.

color RITE
INCORPORATED™

COLORED-CAULK.COM

INSTALLER
STORE.COM
Toll Free: 866-258-1554